

Double-Take® Move

Need a migration solution but not the hassle and expense that usually comes with it? Meet Double-Take® Move: no complexity, no downtime and no platform or environment restrictions, even for X2X migrations.

Double-Take Move revolutionises the migration process with real-time data movement and hardware-independent conversion technology that make workloads simple for administrators to move – and minimises the impact on user productivity. With Double-Take Move behind your migrations, users always have access to data and applications so there's little or no downtime. Operating systems, applications and data are easily moved from one make, model and server configuration to another. Because Double-Take Move is hardware independent, it can also be used for any combination of virtual or physical servers.

No-Downtime Migrations

Unlike solutions that require servers to be offline during migrations, or migrate data from snapshots (leaving behind new data), Double-Take Move does not require servers to be offline during migration; data is mirrored from the old server to the new server without interruption to users. Changes that users make during migration are captured and replicate to the new server in real time. When the mirror is complete and all changes are replicated to the new server, cutover can occur with little to no downtime.

Double-Take® Move continuously captures byte-level changes to a server's OS, applications and data and replicates those changes to new physical or virtual hardware at any location, locally or globally. By moving only the bytes that change, Double-Take Move uses the minimum bandwidth required. What's more, features like Flexible Bandwidth Limiting and Intelligent Compression allow you to control how much bandwidth migration operations

can consume. Migrations can take place during business hours – no more weekends or late nights for IT staff.

Efficient Datacentre Consolidation and Simple Storage Migration

Double-Take Move is the most efficient tool on the market for right-sizing and consolidating datacentres and moving servers between locations. By using WAN-friendly, real-time data replication to move workloads, migrating from Los Angeles to Chicago is as easy as migrating between servers in the same location. For migrating large data sets over a WAN, Double-Take Move can support a physical move (sneakernet) and reconcile the differences before cutting over.

Double-Take Move can migrate to physical or virtual servers that have a different number of drives, drive sizes, CPUs or memory than the original source. A single, uncomplicated interface lets you efficiently manage large migration projects. Easy push-install and license management reduces deployment efforts.

Double-Take Move provides easy, fast, no-downtime migrations, regardless of platform or environment. Double-Take Move is the most efficient tool on the market for consolidating datacentres and moving servers between locations.

Using Double-Take Move, you can migrate the entire system – from simple file servers to custom application servers and domain controllers. Operating systems, applications and data can be moved easily from one make, model and server configuration to another.



PRODUCT DATASHEET- Double-Take® Move

- **Low-impact Migrations**

Double-Take Move mirrors data from the source machine to the new target, even if they are separated by a low-bandwidth WAN. Data can be compressed for transmission and bandwidth usage can be defined to ensure quality of service for users during a migration.

- **No Reboot Required**

No reboot is required for Double-Take Move installation.

- **Push Install**

The migration console pushes Double-Take Move to the new server if necessary, eliminating the need to have Double-Take Move pre-installed on the new server.

- **Seamless Switchover**

Switching to the new server can be executed manually or set up to be fully automatic.

- **Support for Hyper-V and ESX Server**

Virtualise servers to VMware ESX or Microsoft Hyper-V platforms and automatically provision new virtual machines as needed.

X2X Migrations

Using Double-Take Move, you can migrate the entire system – from simple file servers to custom application servers and domain controllers. Operating systems, applications and data can be moved easily from one make, model and server configuration to another. Because it's hardware independent, it can also be used for migrating virtualised workloads back to physical servers should the need arise.

Double-Take Move lets you migrate from a physical server to virtual server or a virtual machine from one virtualisation platform to another. It automatically provisions new virtual machines for you – there's no manual configuration required. With Double-Take Move, you can migrate physical or virtual servers directly into VMware® or Microsoft® Hyper-V™ files, all in real-time.

How X2X Migrations Work

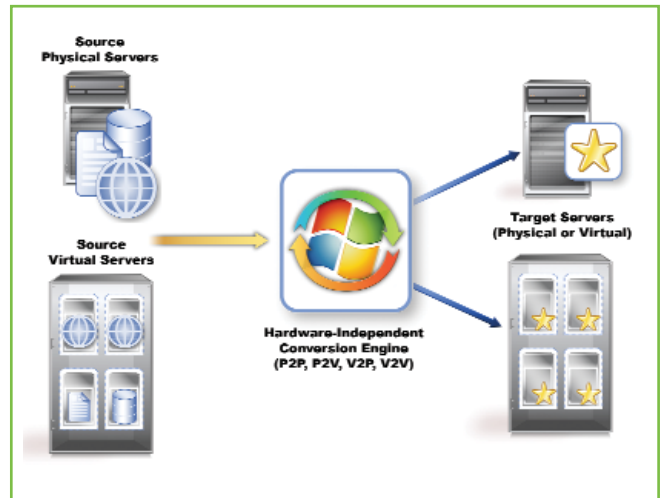

System Requirements

- **Source server**

Operating system – Double-Take Move can migrate a physical or virtual source server running Windows Server 2008 Enterprise, HPC, Standard, Web, Small Business Server, Enterprise x64, or Standard x64, Windows Server 2003 or 2003 R2 Enterprise, Standard, Web, Small Business Server, Enterprise x64, or Standard x64. Each of the Windows 2003 operating systems require Service Pack 1 or later.

- **Target server requirements**

Operating system – (Physical or existing virtual) Windows Server 2008 Enterprise, HPC, Standard, Web, Small Business Server, Enterprise x64, or Standard x64, Windows Server 2003 or 2003 R2 Enterprise, Standard, Web, Small Business Server, Enterprise x64, or Standard x64. Each of the Windows 2003 operating systems require Service Pack 1 or later. (Provisioned virtual) If your target will be provisioned your physical host machine can be Windows 2008 Hyper-V \ or VMware ESX 3.01.

Manage your subscription to eNews. Visit: www.doubletake.com/uk/news-events

Double-Take Move

Get the standard today: www.doubletake.com or 0333 1234 200

© Double-Take Software, Inc. All rights reserved. Double-Take, Balance, Double-Take Cargo, Double-Take Flex, Double-Take for Hyper-V, Double-Take for Linux, Double-Take Move, Double-Take ShadowCaster, Double-Take for Virtual Systems, GeoCluster, Livewire, netBoot/i, NSI, sanFly, TimeData, TimeSpring, winBoot/i and associated logos are registered trademarks or trademarks of Double-Take Software, Inc. and/or its affiliates and subsidiaries in the United States and/or other countries. Microsoft, Hyper-V, Windows, and the Windows logo are trademarks or registered trademarks of Microsoft Corporation in the United States and/or other countries. Linux is a registered trademark of Linus Torvalds. Red Hat is a registered trademark of Red Hat, Inc. All other trademarks are the property of their respective companies.